

XTC SPECIFICATIONS

STYLING

Exterior

- Aerodynamic body shape
- 3mm Silver composite exterior cladding
- Extended Checkerplate to front, sides and rear
- Camec triple locking door with 2 radius corners
- Dometic double glazed windows with integrated blinds and fly screens
- Chrome LED Narva Tail Lamps
- LED Flood lighting to front and rear

Interior

- Modern flush finish solid cabinetry
- Soft closing drawers
- The latest in gloss & matt finish cupboard doors
- Extended leather upholstery with extenda seats
- Storage alcoves to side of bed
- Black Stylish Tap Ware

TECHNOLOGY

- BMPRO charger with odyssey touch panel for battery and tank level monitoring
- 2 x 170 Watt solar panel fitted with digital regulator
- 2 x 100Amp AGM deep cycle battery
- Bluetooth Large Screen DVD/Radio
- 24" LED television
- 2 x TV points
- Wineguard HV TV antenna
- Dometic fan cooled 3 way fridge
- Ibis Mk 4 reverse cycle air-conditioning with remote control
- Washing machine
- Truma ultra rapid stainless steel gas/electric hot water system
- Microwave oven with insert surround
- External mounted - integrated power inlet with circuit breaker
- LED Striplights to kitchen & overhead cabinets
- Waeco reverse camera (car kit supplied loose)
- Narva LED touch lighting interior dimmable roof lights

- 12V/USB fittings to robe cubby holes and Dinette
- Touch sensitive backlit mirror over vanity

SAFETY

- ALKO drop down corner stabilisers
- ALKO electric brakes to all wheels
- Brakesafe breakaway safety system
- Fire extinguisher
- Smoke detector featuring hush button
- Gas regulator and A-frame tap protective covers
- Lockable security door

CONVENIENCE

- Dual 9kg gas bottles
- Extractor fan hatches fitted over toilet and shower
- Raised fridge
- Hydraulic table legs to club lounge models
- Fold down picnic table
- Cutlery tray fitted to kitchen drawer
- Common outlet for all waste water
- Water tap fitted to A frame with stone guard
- External TV entertainment box with Fusion speakers (N/A 705)
- External shower tap set
- China bowl toilet
- Exterior annex lights (2 or 3 x doorside layout dependent and 1 x road side)

NUTS AND BOLTS

- Preston Chassis built Supergal Chassis with extended A-frame and mesh rack
- D035 Coupling
- ALKO Enduro Cross Country independent suspension
- Toolbox fitted to A-Frame with slide out to suit Honda EU21 generator
- Trail A Mate Hydraulic Jack
- All terrain tyres with stylish alloy wheels
- Pull out door step
- Bumper bar with spare wheel mounted

UPGRADE TO XTS...

and get all the great XTC features, plus

- RV Wifi
- 24" Smart TV
- Truma Gas Heater
- Truma Aventa Airconditioning
- 245R16 Wheels and Tyres
- Perspex Glass look Splashback
- Crimsafe Main Door
- Lithium Battery and charger upgrade
- DC to DC Charger
- Extended length Featuring Front Locking Storage Boot
- Pillow top mattress
- 2 Roof hatches

PRACTICALITY

- 6'8" Internal Height
- Concept 'Power Management Cabinet'
- Fibreglass batt insulation to roof
- Styrofoam insulation to walls
- Spacious fully enclosed fibreglass shower to ceiling height
- Towel rail, ring and toilet roll holder fitted to ensuite
- Recessed Oven with electric hotplate
- French made high wear floating vinyl flooring
- Internal and external handles at entry
- Water filter and tap
- Grey water tank



XTC & XTS

[NATURES WINDOW, MURCHISON RIVER, WA]

YOUR PORT HOLE TO
TWO OUTSTANDING VANS



[YOUR TIME IS NOW]

XTC

At Concept Caravans, we're committed to maintaining our highly prized reputation of being producers of the highest quality caravans. The XTC is the evolution of the Concept Ascot, delivering a new personality of it's own. The XTC is manufactured to the exacting standards that are now expected of all Concept Caravans, who are known in the industry for their superlative build quality and are widely recognised as the company that manufactures the caravanner's caravan. The XTC has been designed and built for long term touring in luxury and comfort. The spacious, luxurious interiors are complemented by stylish flush finished furniture, extended upholstery, practical exterior features incorporating silver composite cladding, extended checker plates, triple locking doors and double-glazed windows, sitting atop a Preston built Supergal chassis fitted with ALKO independent suspensions, ensuring the most pleasurable travel and accommodation.



For more photographs & 3D tour, visit CONCEPTCARAVANS.COM.AU

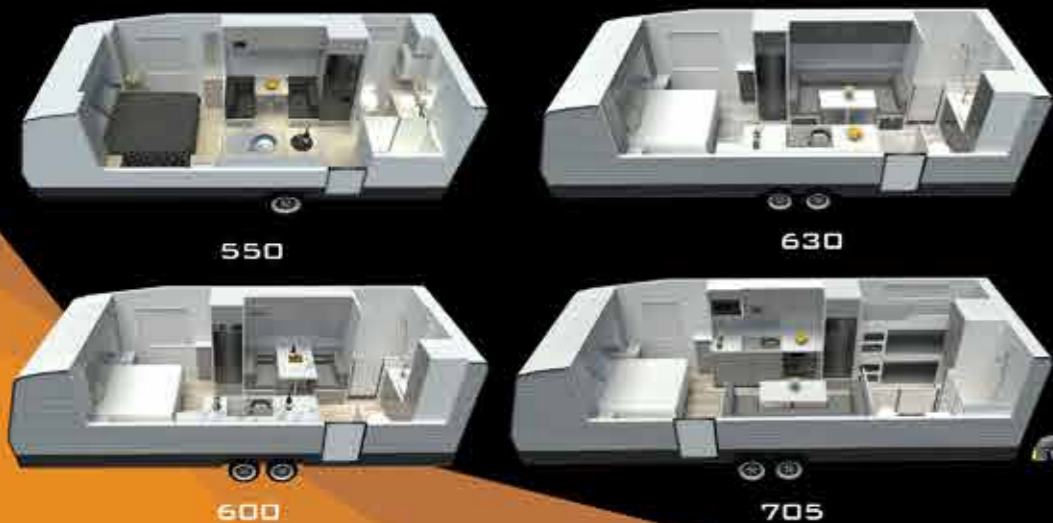

XTS

The XTS sits at the peak of the Concept range. It blends luxury with durability and is configured for extended touring. Built on a Preston Supergal chassis and coupled with an ALKO Enduro suspension system, the XTS sits atop 245 polished alloys, interior boasting Tru-Matt and gloss finishes and leather seating, along with a host of other offerings. This van is our latest masterpiece.



For more photographs & 3D tour, visit CONCEPTCARAVANS.COM.AU

